

Relaxation of Showing Moveable Furniture Items on the Layout Plans for Application for Certificate of Compliance under Clubs (Safety Of Premises) Ordinance

Home Affairs Department



Relaxation of Showing Moveable Furniture Items on the Layout Plans for Application for Certificate of Compliance under Clubs (Safety Of Premises) Ordinance

- Aim:
To provide greater flexibility for the operators to alter their seating layout to suit operation needs
- Common moveable furniture items such as sofas, tables and chairs will no longer be required to be shown on the layout plan for licensing purpose, as long as the no. of persons to be accommodated in various parts of the proposed licensed area are clearly indicated for vetting.

Relaxation of Showing Moveable Furniture Items on the Layout Plans for Application for Certificate of Compliance under Clubs (Safety Of Premises) Ordinance

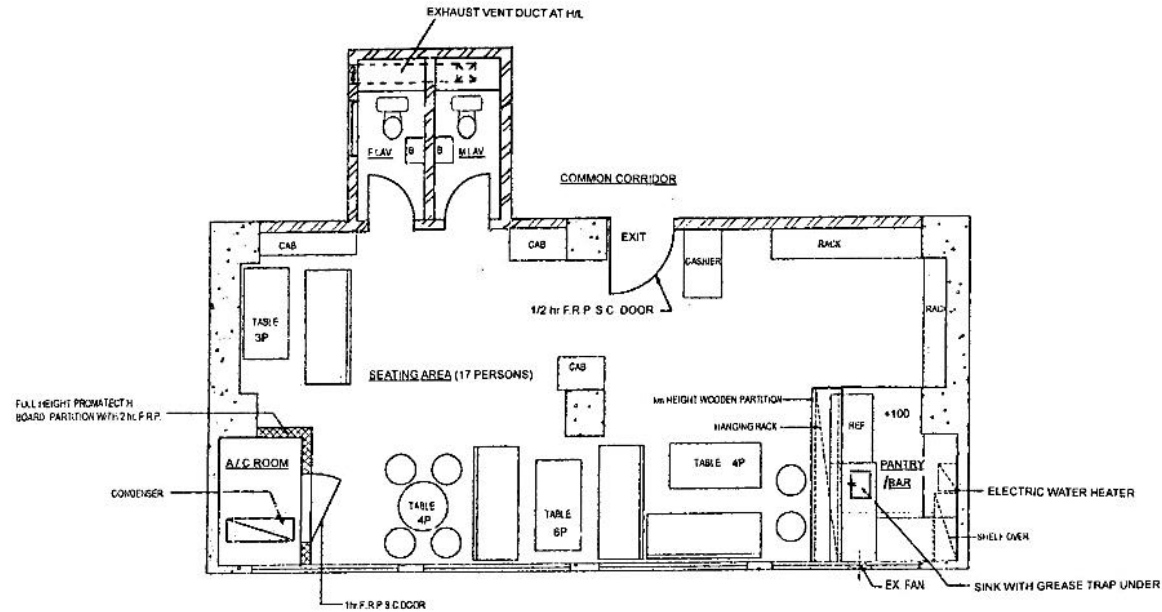

No. of Customer = 17
No. of Staff = 2

NOTE: ONLY ELECTRICITY WILL BE USED FOR COOKING
NO NAKED FIRE WILL BE USED.

SAMPLE LAYOUT PLAN OF ABC CLUB

Scale 1: 100

Current layout plan

Relaxation of Showing Moveable Furniture Items on the Layout Plans for Application for Certificate of Compliance under Clubs (Safety Of Premises) Ordinance

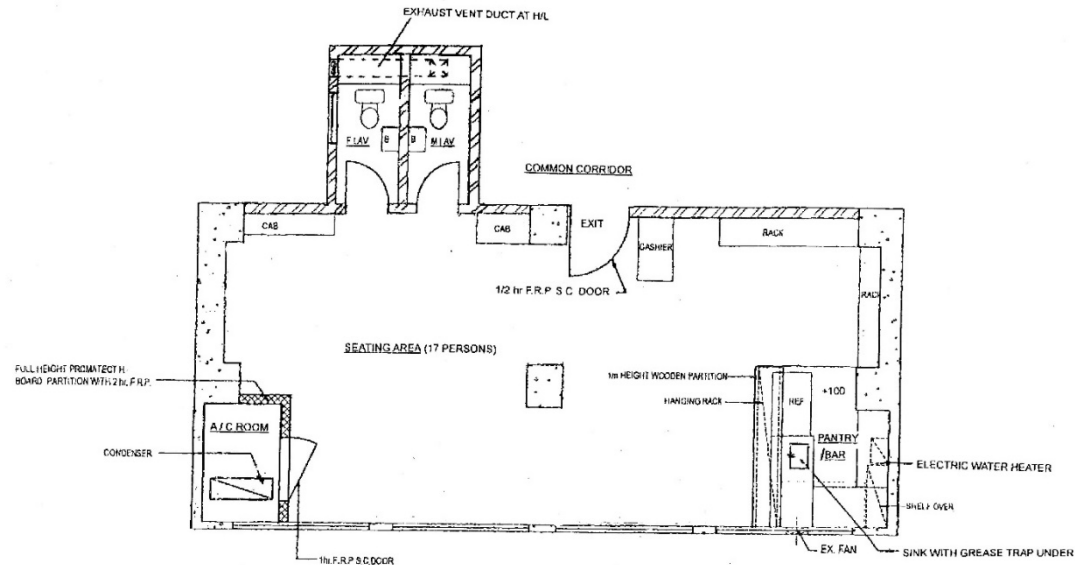

No. of Customer = 17
No. of Staff = 2

NOTE: ONLY ELECTRICITY WILL BE USED FOR COOKING.
NO NAKED FIRE WILL BE USED.

SAMPLE LAYOUT PLAN OF ABC CLUB

Scale 1: 100

- Not require to show moveable furniture
- Clearly indicate the no. of persons to be accommodated in various parts of the proposed licensed area

Relaxation of Showing Moveable Furniture Items on the Layout Plans for Application for Certificate of Compliance under Clubs (Safety Of Premises) Ordinance

● Exceptional Case:

In case where the means of escape provisions has become critical, the OLA may require the indication of moveable furniture on the layout plans to ensure effective control on the maximum number of patrons to the club premises/ satisfactory provision of escape routes.

Table B2: Minimum number and width of exit doors and exit routes from a room, fire compartment or storey

Occupant Capacity of room, fire compartment or storey (No. of persons)	Minimum No. of exit doors or exit routes	Minimum total width (in mm)		Minimum Width (in mm) of each	
		Exit doors	Exit routes	Exit door	Exit route
4- 30	1			750	1050
31-200	2	1750	2100	850	1050
201-300	2	2500	2500	1050	1050
301-500	2	3000	3000	1050	1050
501-750	3	4500	4500	1200	1200
751-1000	4	6000	6000	1200	1200
1001-1250	5	7500	7500	1350	1350
1251-1500	6	9000	9000	1350	1350
1501-1750	7	10500	10500	1500	1500
1751-2000	8	12000	12000	1500	1500
2001-2250	9	13500	13500	1500	1500
2251-2500	10	15000	15000	1500	1500
2501-2750	11	16500	16500	1500	1500
2751-3000	12	18000	18000	1500	1500
>3000 persons - the number of exit doors, exit routes and their width to be determined by the Building Authority					

Relaxation of Showing Moveable Furniture Items on the Layout Plans for Application for Certificate of Compliance under Clubs (Safety Of Premises) Ordinance

- Exceptional Case:

In case where the means of escape provisions has become critical, the OLA may require the indication of moveable furniture on the layout plans to ensure effective control on the maximum number of patrons to the club premises/ satisfactory provision of escape routes.

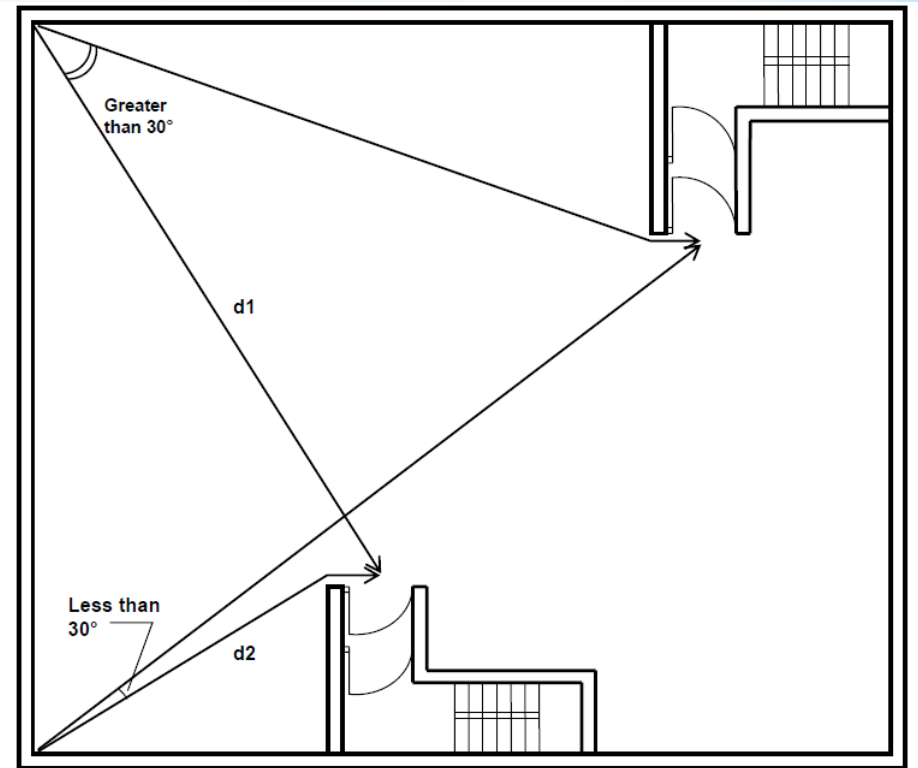

Relaxation of Showing Moveable Furniture Items on the Layout Plans for Application for Certificate of Compliance under Clubs (Safety Of Premises) Ordinance

- Commence since 2nd quarter of 2018
- Facilitate the club operators in the submission of applications and reduce the need for applying for alteration of the seating layout
- Fire safety requirements applicable on furniture remain unchanged

Thank you

Enquiry Hotline : 2881 7034